

# Bernel Road Park Disc Golf Course

**GENERAL:** Disc golf is played like ball golf using a flying disc. The object is to have fun playing the course from beginning to end in the fewest throws.

**TEE OFF:** Tee throws must be released from the tee pad.

**LIE:** The spot where the disc lands.

**THROWING ORDER:** After the tee-off, the player whose lie is the farthest from the basket throws first. The player with the lowest score on the previous hole is the first to tee-off on the next hole.

**FAIRWAY THROWS:** Fairway throws must be made with the foot closest to the basket on the lie. The other foot may be no closer to the basket than the lie. A run-up and follow through is permitted.

**COMPLETION OF HOLE:** A hole is complete when the disc is in the basket.

**OUT OF BOUNDS:** A throw that lands out of bounds must be played from the point where the disc went out (1 Throw Penalty).

**COURSE COURTESY:** Do not throw, until the players or park users are out of range!

For more information visit:  
[www.discgolf.com](http://www.discgolf.com)

This disc golf facility is maintained by:  
Centre Region Parks and Recreation (CRPR)  
(814) 231-3071 [www.crpr.org](http://www.crpr.org)

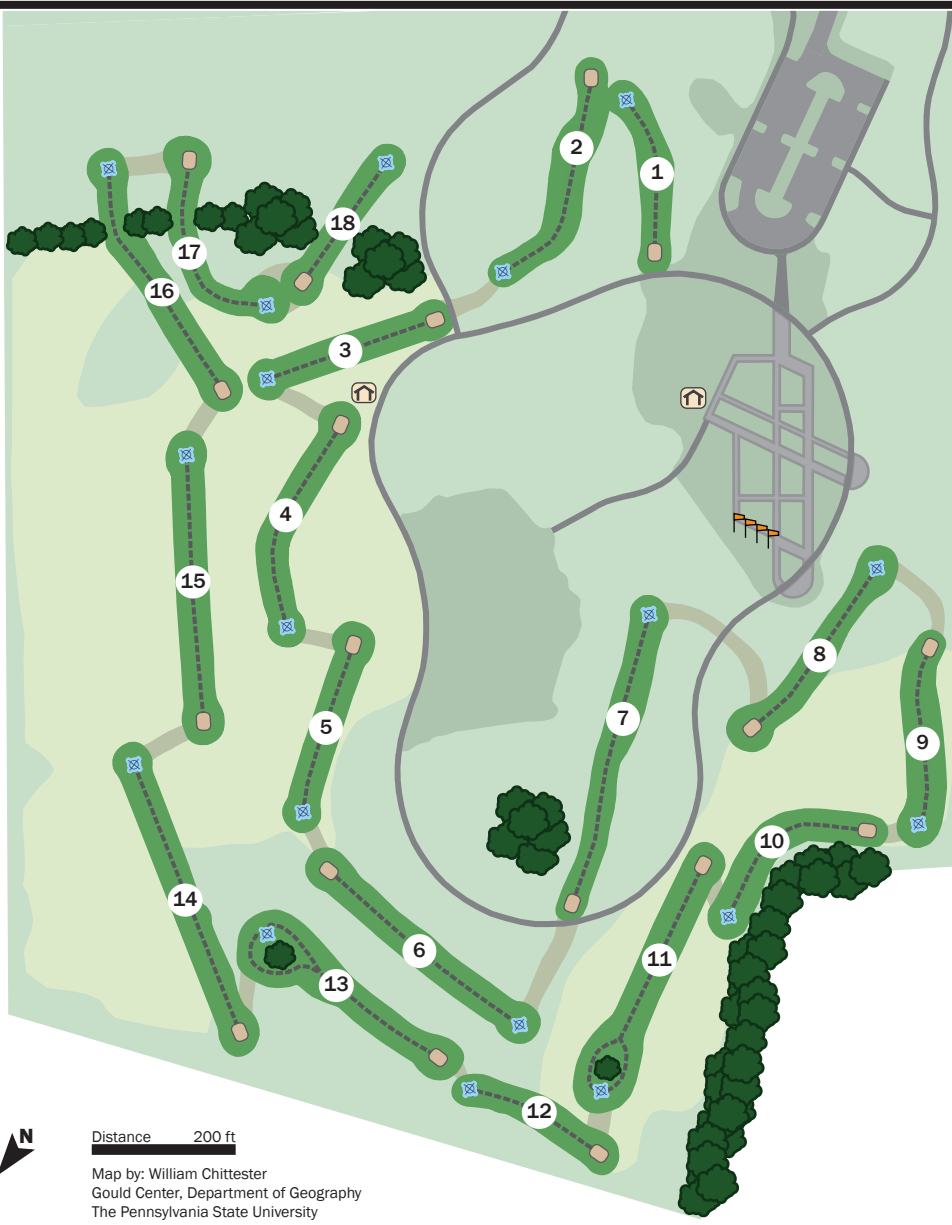

Distance 200 ft  
Map by: William Chittester  
Gould Center, Department of Geography  
The Pennsylvania State University

Hole	1	2	3	4	5	6	7	8	9	10	11	12	13	14	15	16	17	18	TOT
Par	3	3	3	3	3	3	3	3	3	3	3	3	3	3	3	3	3	3	54
Distance (feet)	225	330	245	305	240	340	420	255	280	250	355	205	305	400	370	355	285	205	5370